



**just
for
me**

**A day at
Frost Science**

Today I will visit the Phillip and Patricia Frost Museum of Science.

Some people call it Frost Science.

There will be a lot for me to see and touch.





If I take public transportation or walk to the Museum, I will enter here.



If I come in a car and park in the garage, I will enter here.

All Museum visitors are greeted by a staff member when they walk in.

This will be the first thing I do.

The staff will be sitting at the ticket counter at the entrance of the Museum.





A staff member will give me a wristband. I need this wristband to enter the Museum. The wristbands can be any color and will be made of paper or cloth.

If I want, I can wear my wristband on my wrist. It does not hurt. I can choose to have the staff member or my adult put on my wristband.

I can also have an adult I am with wear my wristband for me. Either choice is okay!

Frost Science staff wear a blue shirt with a badge or lanyard and a name tag. They might also be wearing a navy blue jacket.

**They are adults that can answer my questions.
They can also help me if I get lost.**



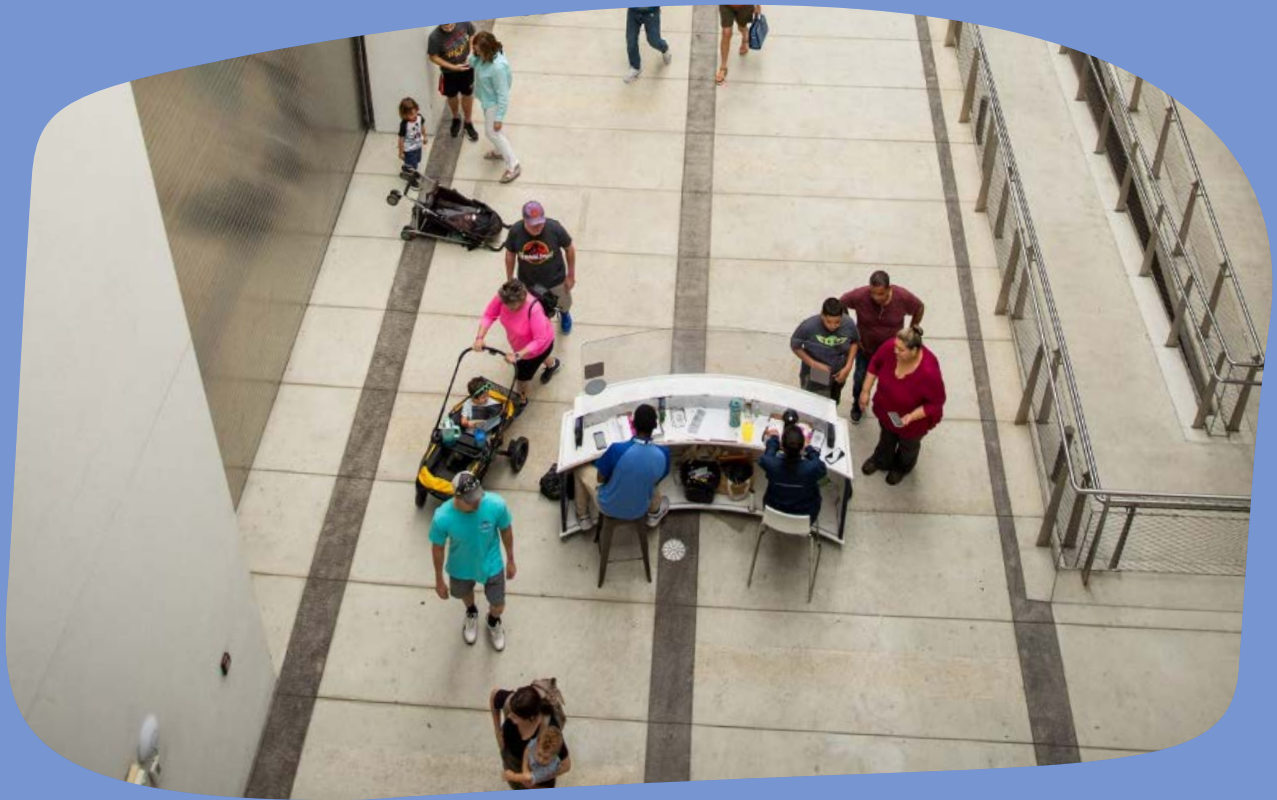

There will probably be other guests at the Museum when I arrive or who arrive at the same time as me.

They might also be excited to explore, so they could be noisy.



The group I am with will get a map of the Museum.

I can visit all the exhibitions.

During Just for Me hours, there will be one exhibition with special activities where I can learn about science in my own way and at my own speed.

The restrooms I can use will be on the first floor, the third floor, and the fourth floor.

They are located near the walls with blue tile.





**When I move through the Museum,
there are many exhibitions to see.**

Some I can touch. Some I cannot touch.

**The adult I am with and Frost Science staff
can help me understand which exhibits are
for touching and which are just for looking.**

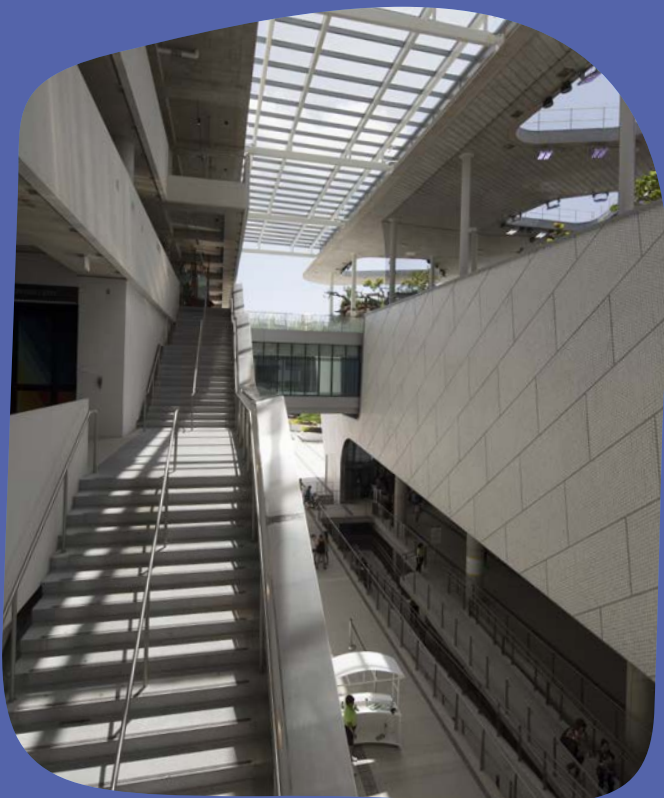

I can move between floors of the Museum using the stairs or the elevator.

One of the exhibitions I might see is called Power of Science.

Here I will learn about famous scientists, the importance of protecting our oceans, how scientists are studying the human body, and new research about our universe.

There is a dance floor in this exhibition that lights up when I step on it. Sometimes the lights in the room are dimmed. I will see bright neon colors.





If I need a quiet space, I can walk up the ramp or the stairs in Power of Science to get to the Oculus.

Here there are fish and sharks swimming over my head. But they are in a big aquarium, so I am safe!

I can relax under the Oculus for as long as I need or until my group decides it is time to go.

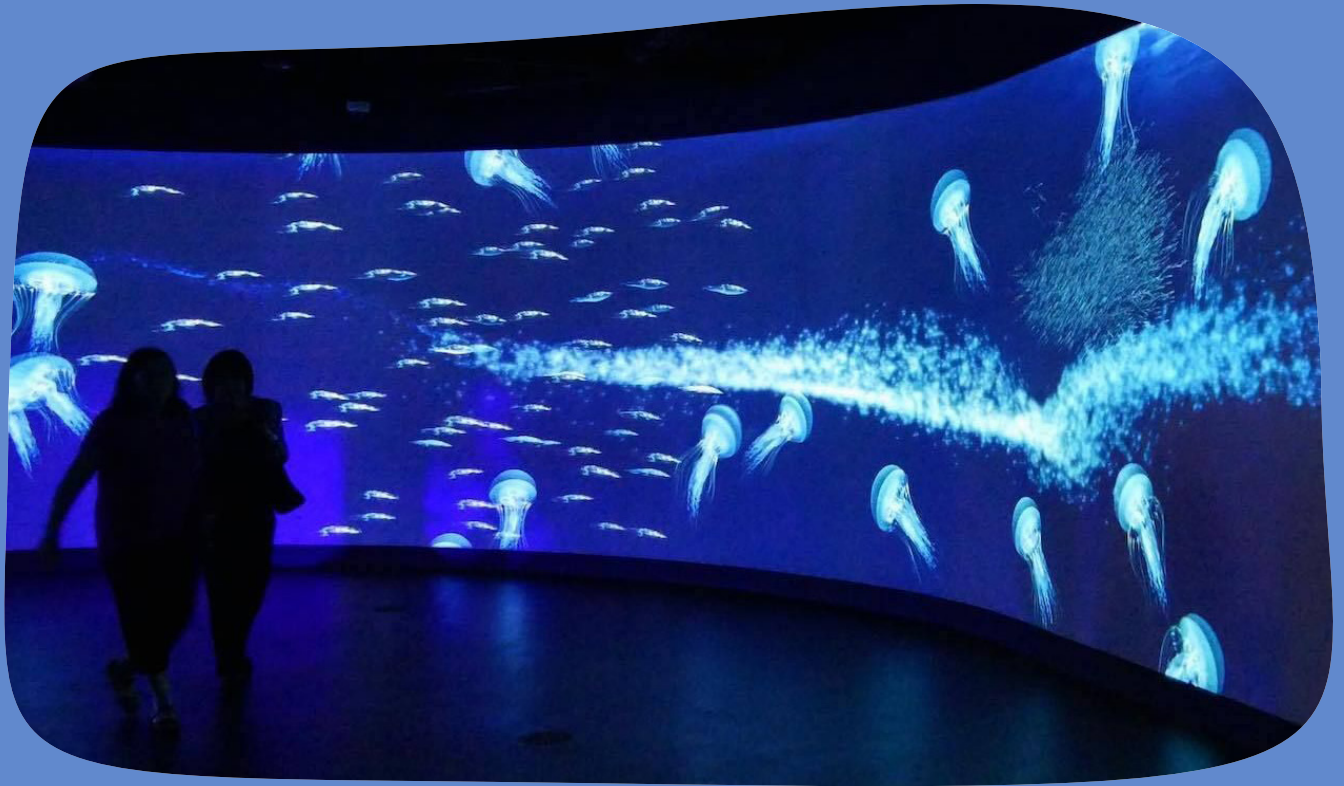

From the Oculus, I can begin to explore the Aquarium, starting from The Deep.

The Deep is a dark hallway where I will see aquariums full of jellies and a video of fish, whales and sharks swimming on a long wall.

The floor above The Deep is called The Dive. Here I will see different aquariums with many different types of fish and marine life.

The floor about The Dive is called The Vista, where I can see the fish from above.

On The Vista I can also see birds and reptiles and even touch a stingray, if I want.





Other exhibitions I can see include MeLab and Feathers to the Stars.

These are about the human body and flight.

In Feathers to the Stars, I can even make my own paper airplane!

At some point during my visit I might go to the Planetarium for a show.

It will be like going to the movies.

My group will need to leave strollers outside, if possible.

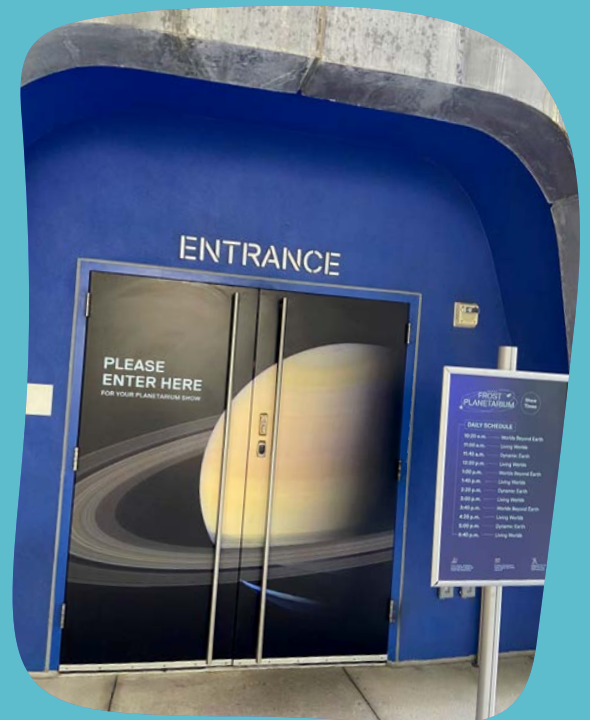

I will follow the directions of the staff to enter the Planetarium.

The walk will be dark, but it is short.





The Planetarium is a round, dark room and sometimes the sound is loud.

If I feel uncomfortable, an adult in my group can help me leave the Planetarium before the show is over.

I will exit the Planetarium either the same way I entered or through doors at the top.



There is a place to buy food and drinks at Frost Science. It is called Food@Science.

If it is open during our visit, my group and I can decide together if we want to buy something to eat.



**There is also a store at the
Museum called the Science Store.**

**It is located near the entrance and exit.
There are lots of items to see.**

**If I have permission from an adult in my
group, I may be able to buy something.**



**I will listen to the adults in my group.
I will have a good day and stay with my group.**

**When it is time to go, I will leave the
Museum the same way I entered.**

Use this page to decide where you want to go in the museum, based on what **you** like best!

I like...

Airplanes & Space ↔ **Feathers to the Stars**

Fish ↔ **The Dive**

Sharks ↔ **The Oculus**

Jellies ↔ **The Deep**

Dancing ↔ **Power of Science**

I am ready for a fun day!

FROST
SCIENCE

